

Symbol / Features

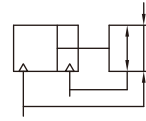

- 1. Parallel type, suitable for internal and external gripping.
- 2. Built-in Magnet.

Specifications

Bore OD	mm	50	64	80	100	125
Open / Close Stroke	mm	8	12	16	20	26
Action		Double Acting				
Fluid		Air				
Operating Pressure Range	MPa (kgf/cm ²)	0.1 ~ 0.6 (1.0 ~ 6.1)				
Operating Temperature Range	°C	-10 ~ 60 (No Freezing)				
Lubrication [Ⓞ]		Not Required				
Cushion		No				
Repeatability	mm	± 0.05				
Max Operating Frequency	c.p.m	90				
Port	Side Ported	M5X0.8			Rc1/8	
	Axial Ported	OR3X1.0 (O-ring)			OR5X1.5 (O-ring)	
Mass	kg	0.25	0.50	0.90	1.55	2.75

Note: ① Use only Turbine Oil ISO VG32 for lubricant, if required.

Order Code

MHG4	—	50		D
Series ^①	—	Bore OD mm		Port ^②
		50	∅50	Nil
		64	∅64	Side
		80	∅80	D
		100	∅100	Axial
		125	∅125	

- Note: ① Auto switch needs to be ordered separately.
- ② please refer to the Auto Switch Selection Table.

Order Example

Bore OD = 80mm, MHG4 Series, Order Code: MHG4 - 80
 Bore OD = 125mm; with Auto Switch (Refer to 4.03 TD series, Model: TD , length 2 meters), MHG4 Series.
 Order Code: MHG4 - 125
 Auto Switch Order Code: TD-2000 (Normally, each cylinder will installed 2 Auto switches)

• Auto Switch

Bore Size (mm)	2-wire		3-wire
	Contact	Solid State	Solid State
50, 64	TD	TDW	TDS
80, 100		TDX	TDLFS
125		TDTX	TDLMN
		TDLFX	TDLMP

Constructions

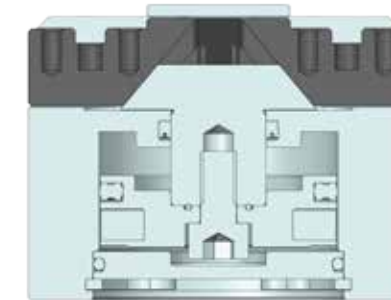

Bore OD (mm)	Compression Area (mm ²)		Angle Between Guide and Piston Direction
	Finger Close	Finger Open	
50	691.2	804.2	40°
64	1055.6	1256.6	
80	2803.0	3117.0	
100	4535.6	5026.5	
125	7363.0	7854.0	

Effective Gripping Force

• Internal Clamp Gripping Force

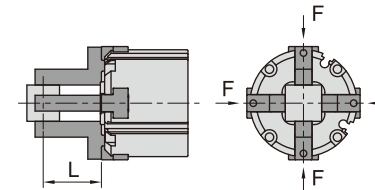

MHG4-50

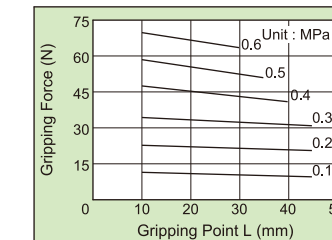

MHG4-64

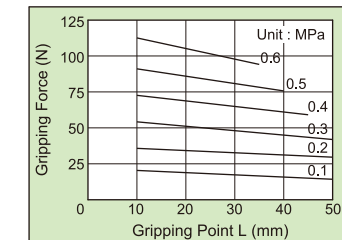

MHG4-80

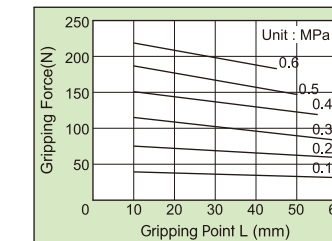

MHG4-100

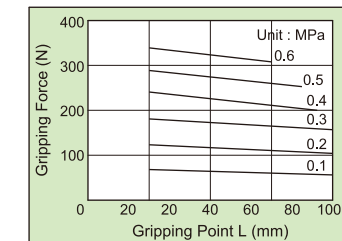

MHG4-125

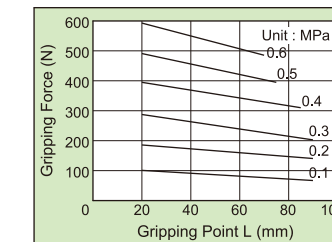

Gripper - 4 Fingers
MHG4 (50 - 125) Series

Gripper - 4 Fingers
MHG4 (50 - 125) Series

Effective Gripping Force

• Internal Clamp Gripping Force

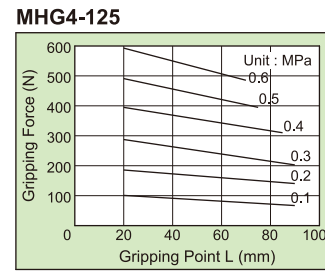
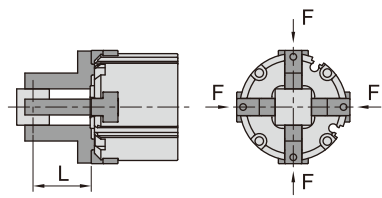

• External Clamp Gripping Force

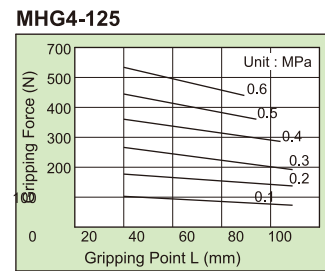
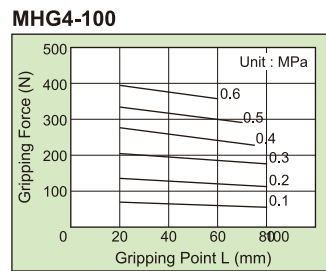
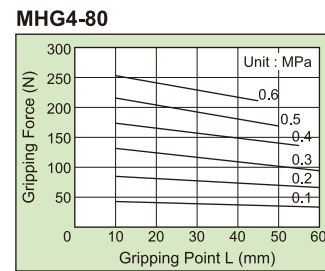
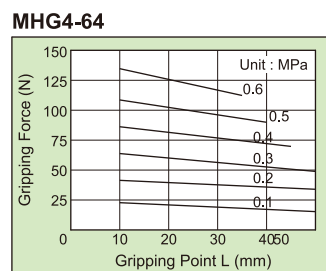
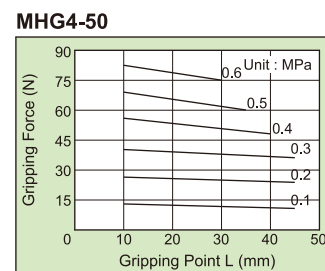
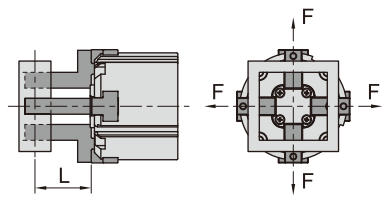

Ext. Dimensions [mm]

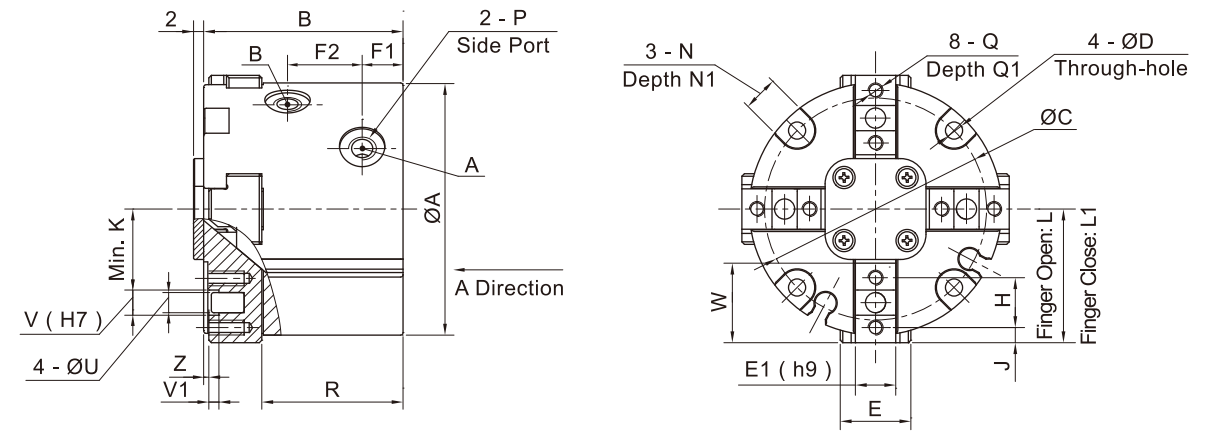

• Ø50 , Ø125

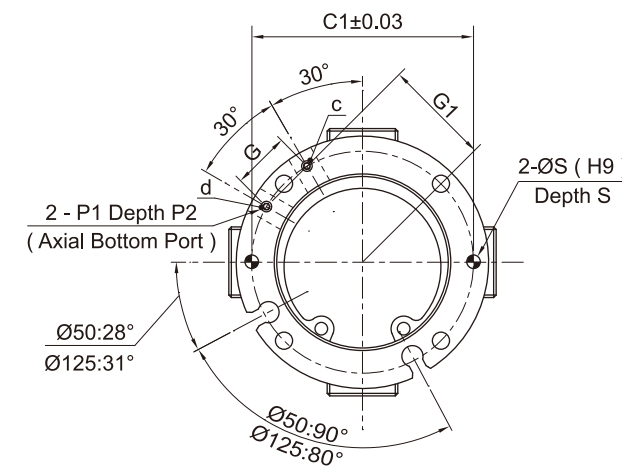

• Ø64 - Ø100

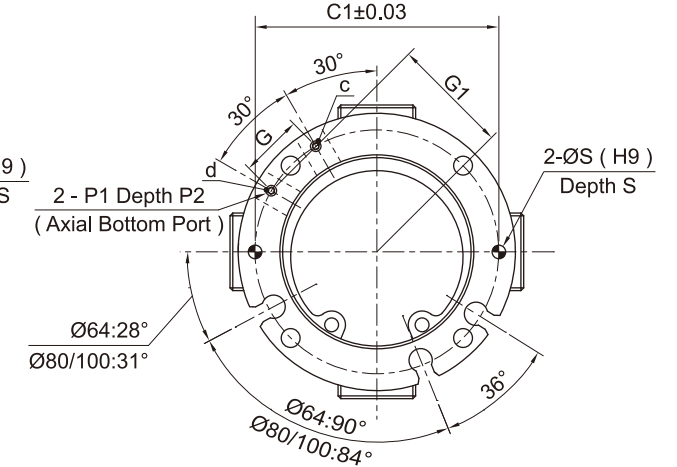

Note: Port A/B: side port; Port c/d: axial bottom port.

Bore OD	A	B	C	C1	D	E	F1	F2	G	G1	H	J	K	L	
50	50	39	45	45	3.4	14	8	8	14.8	15	18.5	12	3	15	30.5
64	64	47.5	56	56	5.5	17	10	10	16.5	18	25	13	4	19	38
80	80	56.5	70	70	6.5	23	12	10	22	18	32	16	5	26	50
100	100	65	90	90	6.5	27	14	12	24	24	42	20	6	32	62
125	125	76	112	112	8.5	30	16	13.5	28.5	30	53	24	8.5	41	78.5

Bore OD	S	L1	N	N1	P	P1	P2	Q	Q1	R	U	V	V1	W	Z
50	3	26.5	7	5	M5X0.8	M3X0.5	4	M3X0.5	7	28	4	5	2	18	—
64	4	32	10	6	M5X0.8	M3X0.5	4	M4X0.7	8	32	4	5	2.5	20	2
80	5	42	11	7	M5X0.8	M3X0.5	4	M5X0.8	9	39.5	5	6	3	25	3
100	5	52	11	7	Rc1/8	M5X0.5	4.5	M6X1.0	12	46	6	8	3	32	3
125	6	65.5	15	9	Rc1/8	M5X0.8	4.5	M6X1.0	12	53.5	6	8	3.5	40	3

Gripper - 4 Fingers MHG4 (50 - 125) Series

End Effector - Magnetic Type MGA 30 - 68 Series



Port Connection

• Side Ported

1. A, B: side port.
2. c, d: axial bottom port with plug.
3. A, B port can be directly mouted with quick couplers.

• Axial Bottom Ported

1. c, d: axial bottom port;
2. Port A, B: side port with plug;
3. When use the ports, it should be work together with O-ring and adapter plate, see the above diagram:

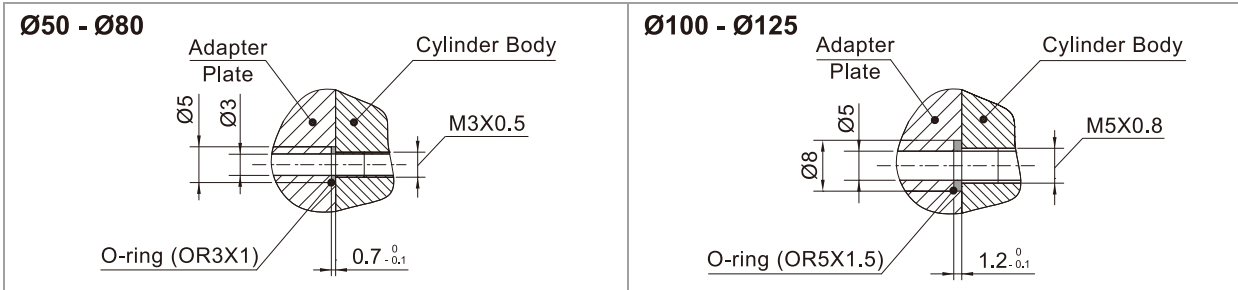
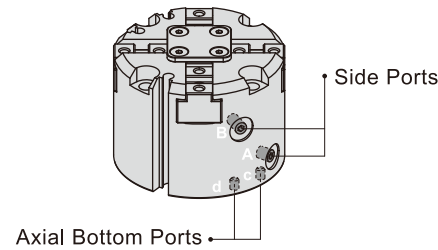

Symbol / Features

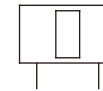

1. Suitable for steel plates, sheet metals with holes or workpieces with uneven surfaces.
2. Quickly switch of holding or releasing working states.
3. Front-set bumper, high holding force, and bumper can be replaced quickly.
4. Holds workpieces evenly when air is shut off.
5. Lightweight and compact design.



Specifications

Magnet Model	mm	30	40	50	68
Bore Size	mm	16	25	32	50
Magnet Diameter	mm	Ø30	Ø40	Ø50	Ø68
Action		Double Acting			
Fluid		Air			
Operating Pressure Range	MPa (kgf/cm ²)	0.25 ~ 0.6 (2.5 ~ 6.0)			
Operating Temperature Range	°C	-10 ~ 70 (No Freezing)			
Lubrication ^①		Not Required			
Holding Force ^②	N	35	100	180	290
Residual Holding Force	N	0.25	0.25	0.25	0.30
Port	Rc	1/8			
Mass	kg	0.16	0.30	0.55	1.05

Note: ① Use only Turbine Oil ISO VG32 for lubricant, if required.
 ② It's only a theoretical holding force, not include the safety factor. Usually the safety factor is 3 when transfer steel plate of 2 mm thickness.

Order Code

MGA Series ^①	50 Magnet Diameter mm
	30 Ø30
	40 Ø40
	50 Ø50
	68 Ø68

Note: ① Auto switch needs to be ordered separately, please refer to the Auto Switch Selection Table.

Order Example

Magnet Diameter = 50mm , MGA Series.

Order Code: MGA50

Magnet Diameter = 40mm; with Auto Switch (Refer to 4.03

TD series, Model: TDX , length 2 meters), MGA Series.

Order Code: MGA40

Auto Switch Order Code: TDX-2000 (Normally, each cylinder will installed 2 Auto switches)

• Auto Switch

Magnet Diameter (mm)	2-wire		3-wire
	Contact	Solid State	Solid State
30, 40 50, 68	—	TDW TDX	TDS